



# RAISE THE WOOF

SPCA EAST TEXAS

# OUR JOURNEY

I began my work in animal welfare in 2007 as a volunteer. At that time, neither the City of Tyler nor Smith County operated animal shelters. As a result, those entities, as well as surrounding towns, were forced to deliver stray dogs and cats to the local Humane Society. In 2007 alone, 10,453 pets were delivered to that small, overrun, overworked and outdated facility. Tragically, 6,996 of those pets were euthanized due to overcrowding.

In the following years, animal welfare in the community became even more fractured and ineffective; jail inmates worked in dilapidated metal barns serving as animal control and truckloads of euthanized animals had to be frozen and transported to Jacksonville for cremation. The situation intensified when the Director of the local Klein Shelter was arrested for animal cruelty forcing the immediate closure and disruption of the minimal services available.

In 2010, the decision was made to form SPCA East Texas to address the overpopulation and mass euthanasia of homeless dogs and cats. While some community shelters have been built since then, this issue continues to plague East Texas. The need for our services has never been greater as the homeless pet population in our area continues to surpass the national average.

Through rescue, adoption, affordable spay/neuter, transport, and microchipping, we continue to make progress in reducing the number of homeless animals in our area. With your support, SPCA East Texas will continue to rescue hundreds of homeless pets each year.

Sincere gratitude,

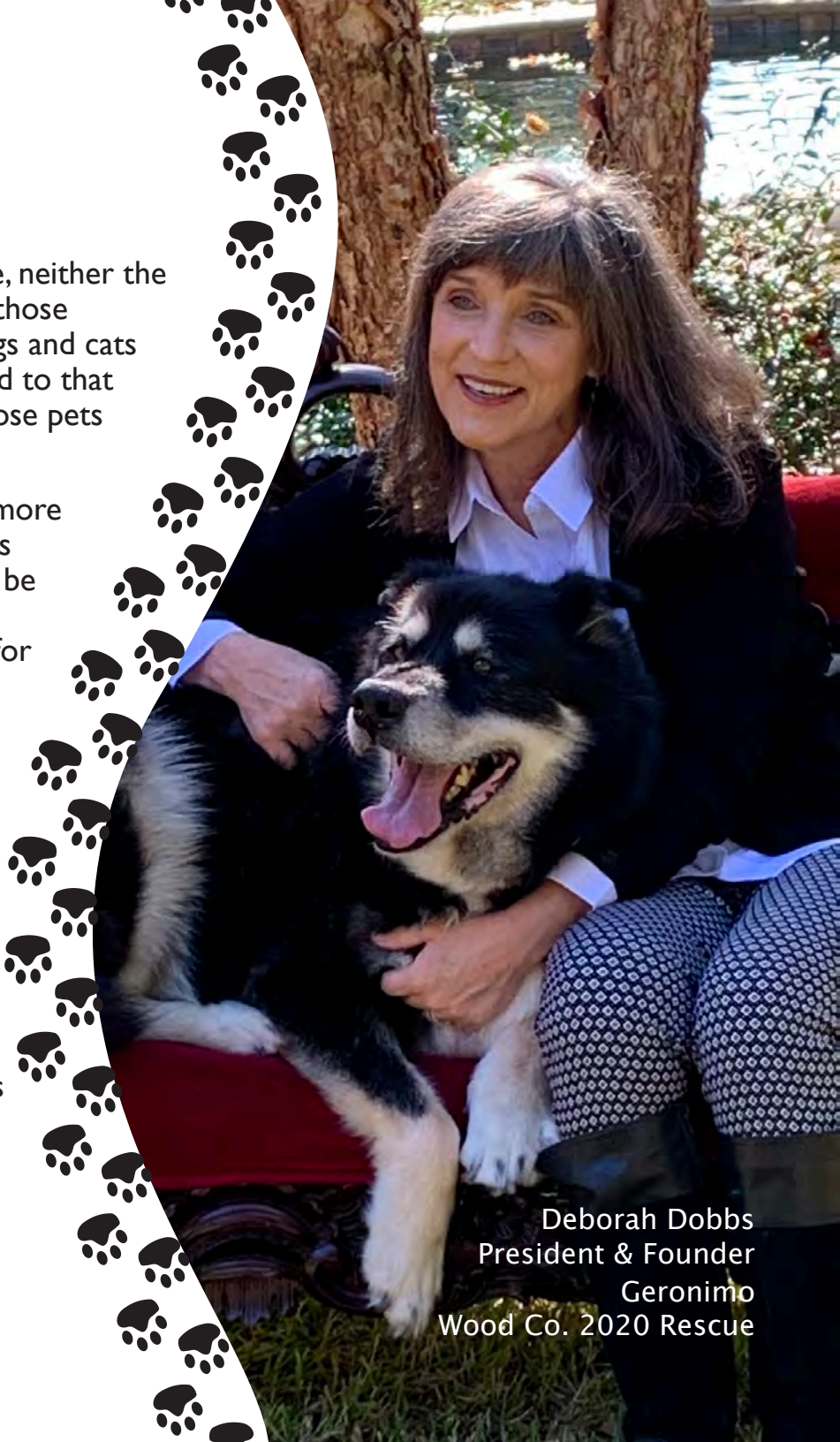

Deborah Dobbs  
President & Founder  
Geronimo  
Wood Co. 2020 Rescue





Beason Family with SPCA Alumni Stella

# OUR IMPACT

SINCE 2010...

**6,000+**

PETS RESCUED

**27,500+**

SPAY & NEUTERS

**44,000+**

COMMUNITY PETS SERVED

**12,200+**

PETS MICROCHIPPED



# OUR MISSION IN ACTION

## RESCUE



Coordinated, safe, humane removal, relocation and rehabilitation of abandoned and endangered pets.

## ADOPTION



Personalized placement of homeless pets into loving forever families.

## CRUELTY & NEGLECT



Hotline for reporting and responding to pets in critical situations.

## AFFORDABLE SPAY/NEUTER & WELLNESS



Providing high quality, affordable services to the public.



## BOSSART BARK PARK



8 beautiful acres of fenced dog park for our community to enjoy.



## EDUCATION

Teaching pet responsibility and kindness to all age groups.

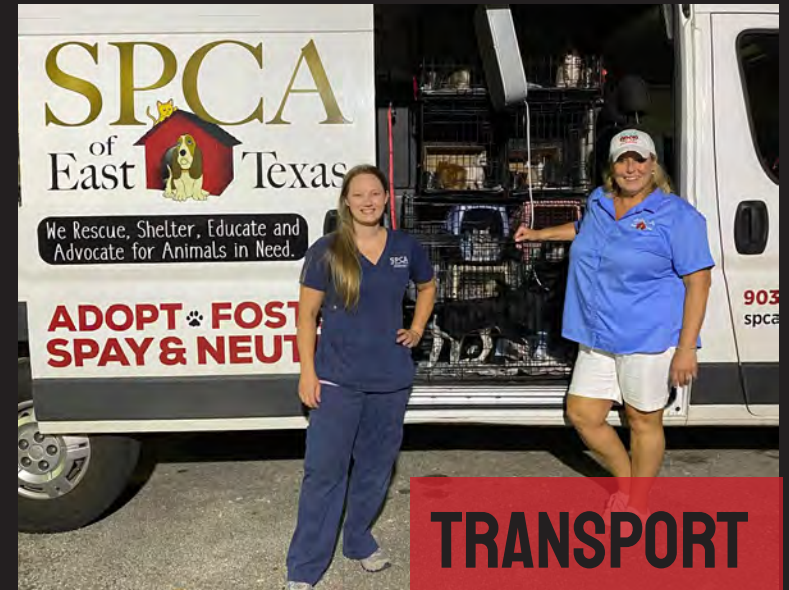

## TRANSPORT

Relocating and rehoming dozens of homeless pets each month to families in the Northeast.



## FOSTER

Providing loving foster families to homeless pets for socialization before adoption.



# OUR COMMUNITY PROGRAMS



Community Assistance  
Recipient “Miss Bonnie”



Hospitalized  
Navy Veteran “Billie”



Alzheimer’s Alliance Day Club

- **Emergency Housing Program** provides free assistance for pets whose owners are suddenly hospitalized, fleeing domestic violence, or homeless due to unforeseen circumstances.
- **Community Assistance Program** provides emergency services and end-of-life care to pets whose owners are experiencing personal or financial difficulties.
- **Community Pet Food Pantry** provides free dog and cat food to pet owners in need.
- **Dog and Cat Sanctuary** provides loving lifetime care should a pet outlive their owner.
- **Supporting Local Agencies** such as the East Texas Crisis Center, Hunger for Love, Veterans, UT Behavioral Health and Briarcliff Health Center.

# OUR NEEDS

Our programs cannot be sustained without the tools necessary to effectively operate on a daily basis, 365 days a year.

The Raise the Woof Campaign will create a state-of-the-art animal campus for housing all our programs under one roof.

This much improved and updated setting will better serve the homeless pets of our community, reduce operating costs and maximize staff potential.

- More indoor space to reduce stress for animals and staff
- Separate dog and cat isolation for ill and contagious animals
- Private nursery for nursing litters and expectant moms
- Improved air flow quality with routine air exchange
- Large, enhanced indoor play areas
- Increased program capacity
- Modern and efficient plumbing, heating & air conditioning systems
- Abundant sunlight for long term residents
- Centralized location for staff and volunteers





# OUR NEW HOME STARTS WITH YOU







SPCA East Texas has developed a formal plan for maximizing our potential.

Animal welfare is at the forefront of everything we do at SPCA East Texas and we fully understand the needs of homeless pets. We also acknowledge that our current facilities do not efficiently and effectively maximize our services.

With the recent purchase of a 16,000 sq ft building located in the heart of our community, this new campus will adjoin our existing 60 acre tract.

With your help, we can **Raise the Woof** to fully renovate our new home, consolidate operations and serve the community for many years to come.





Existing Floor Plan

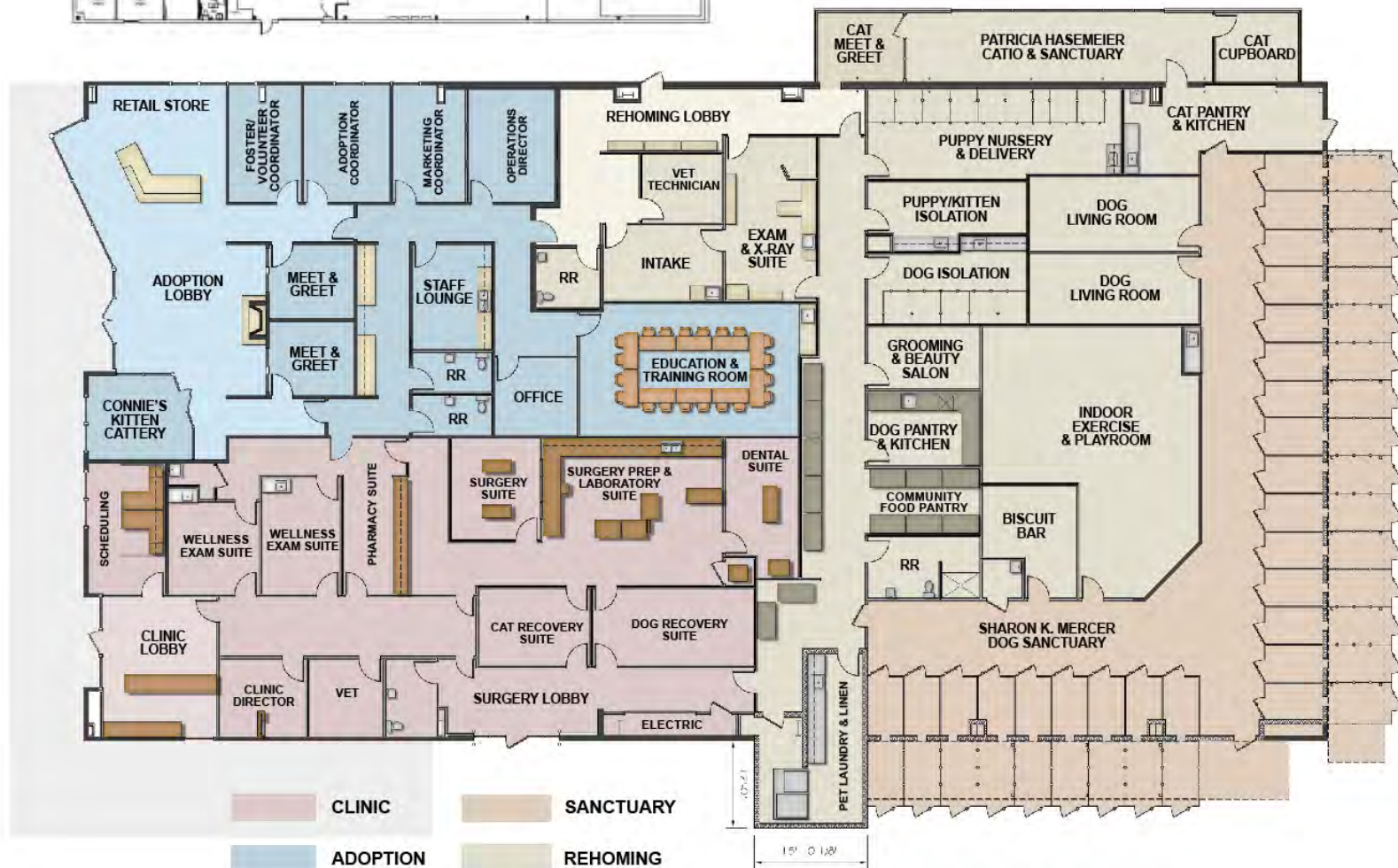





**Adoption Lobby  
and Retail Space**

**Kitten Cattery**



# YOU'RE INVITED TO RAISE THE WOOF

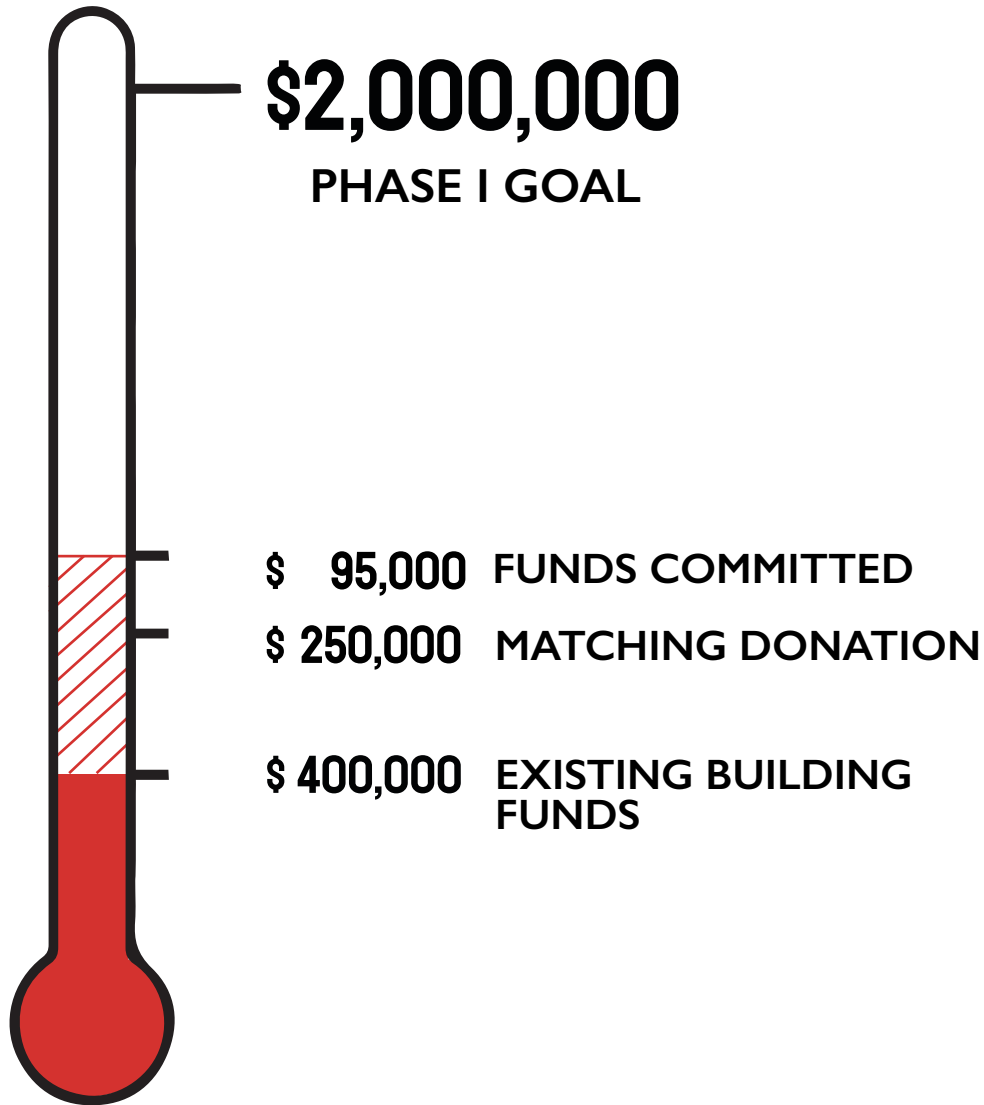

## 3 YEAR PLAN

Phase I  
Renovations & Equipment  
\$2,000,000

Phase II  
Satisfy Mortgage  
\$1,600,000

Phase III  
Establish Endowment Fund  
\$500,000

---

**TOTAL CAMPAIGN GOAL**  
**\$4,100,000**



# HOW CAN YOU MAKE A BIG IMPACT?



- **Gifts of Cash:** The easiest and most direct way of supporting this campaign is a cash donation.
- **Schedule a Monthly Gift:** Monthly giving is sometimes preferred and enables donors to easily achieve their desired level of giving over a period of time.
- **Matching Gifts:** Many corporate employers will match their employees' gift to a 501(c)3 nonprofit. If your company has such a program, please request their matching gift form and send the completed form to us. We will take care of the rest.
- **Gifts of Stock:** Avoid capital gains through a gift of stock, while taking a full-value deduction on your tax returns.
- **Qualified Charitable Distributions:** If you're over age 70½, you can meet the required minimum distribution from your IRA by making a qualified charitable distribution of up to \$100,000 per year; you'll also lessen your taxable income.
- **Multi-Year Pledge Commitment:** Enables donors to make an annual gift over a 3 year period to achieve their desired level of giving.



# SPONSORSHIP LEVELS

Sponsors Permanently Recognized on Wall of Giving

Fiercely Loyal		\$100,000+
Eager to Please		\$75,000+
Fabulous Friend		\$50,000+
Devoted & Dependable		\$30,000+
Faithful & Feisty		\$20,000+
Miracle Worker		\$10,000+
Kindhearted & Inquisitive		\$5,000+





# COMMEMORATIVE NAMING OPPORTUNITIES

SPCA East Texas is honored to recognize individuals and businesses who make significant contributions to our new home and lifesaving programs.

<b>Surgery Suite</b>	<b>\$100,000</b>
<b>Adoption Lobby</b>	<b>\$100,000</b>
<b>Outdoor Play Yard</b>	<b>\$100,000</b>
<b>Permatek Flooring</b>	<b>\$100,000</b>
<b>Education &amp; Training Room</b>	<b>\$75,000</b>
<b>Indoor Exercise &amp; Playroom</b>	<b>\$75,000</b>
<b>Outdoor Splash Pad</b>	<b>\$75,000</b>
<b>Intake Exam Suite</b>	<b>\$75,000</b>
<b>X-Ray Machine</b>	<b>\$75,000</b>
<b>Puppy Nursery &amp; Delivery Suite</b>	<b>\$50,000</b>
<b>Surgery Prep &amp; Laboratory</b>	<b>\$50,000</b>
<b>Pharmacy Suite</b>	<b>\$50,000</b>
<b>Dental Suite</b>	<b>\$50,000</b>
<b>Grooming &amp; Beauty Salon</b>	<b>\$50,000</b>
<b>Transport Van</b>	<b>\$50,000</b>
<b>Ultrasound Machine</b>	<b>\$50,000</b>
<b>Office Computers &amp; Furnishings</b>	<b>\$50,000</b>
<b>Dog Isolation Suite</b>	<b>\$30,000</b>



Puppy & Kitten Isolation Suite	\$30,000
Dog Living Room	\$30,000
Dog Surgery Recovery	\$30,000
Cat Surgery Recovery	\$30,000
Anesthesia Machines	\$30,000
Diagnostic Laboratory Machines	\$30,000
Cat Kitchen	\$20,000
Dog Kitchen	\$20,000
Clinic Lobby	\$20,000
Surgery Lobby	\$20,000
Rehoming Lobby	\$20,000
Surgery Lights	\$15,000
Autoclave	\$15,000
Cat Meet & Greet Room	\$10,000
Dog Meet & Greet Room	\$10,000
Biscuit Bar	\$10,000
Cat Cupboard	\$10,000
Wellness Exam Suites	\$10,000
Community Food Pantry	\$10,000
Pet Laundry & Linen	\$10,000
Staff Lounge	\$10,000
Oxygen Concentrators	\$10,000
Surgery Tables	\$7,500
Surgery Prep Table	\$7,500
Critical Care Patient Monitor	\$7,500



# HOW WE USE OUR DONATIONS

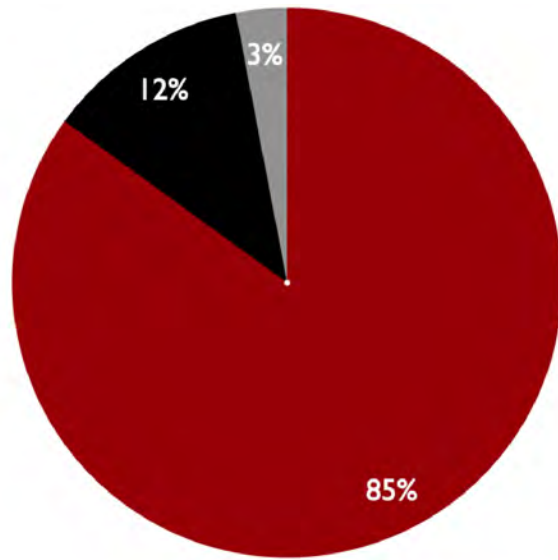

**85¢**  
of every dollar goes directly  
to our lifesaving programs.

● Programs ● Fundraising ● Operations

When you donate to SPCA East Texas, 100% of your gift remains in our community.  
Your dollars directly support our important programs in saving thousands of homeless pets.

We are a local and independent nonprofit organization.  
We are not affiliated with any other nonprofit organizations.  
We do not receive government funding or tax dollars.

Please consider keeping your dollars local by donating to SPCA East Texas.



SPCA  
of East Texas



SNIPPET  
CLINIC

Affordable  
Spay/Neuter  
&  
Vaccinations

803-92-7705



**SPCA East Texas Team**

**Recipient of "Locals Love Us" Award for 3 Consecutive Years**



# THANK YOU

## SPCA East Texas 2022 Board of Directors

BARBARA SKEEN  
Chairman of the Board

BRENT BOSSART

CONNIE GREENBERG

TIFFANY HILL  
Chairman Elect

RHONDA BOSSART

TODD HILL

DESTINI BOWLING

HUNTER RUSH

DEBORAH DOBBS  
President & Founder

SARAH BRYAN

MELISSA SHELTON

BOBBIE BURKS

CINDI FEATHERSTON-SHIELDS

LESLIE HARRISON  
Secretary

DAVID DOBBS

ROB SHIELDS

ELLEN PEIRCE  
Treasurer

DON GARRETT

JONATHAN WRIGHT

ROSE GILES



PO BOX 132899 Tyler, TX 75713

(903) 596 - 7722

[www.spcaeasttx.com](http://www.spcaeasttx.com)